

# PRE PAINTED PANEL BOARD INSTALLATION

Before installation: check the panel for any damage or difference in color.

Huntonit is a natural product made of wood fiber pulp; variation in color and appearance may occur. It is recommended to use panel from the same production or batch number.

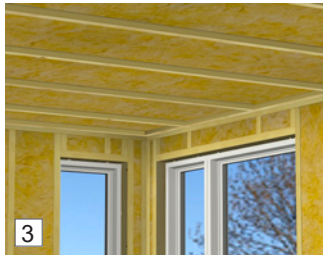
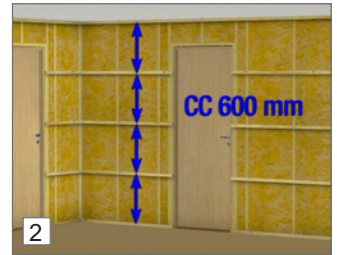
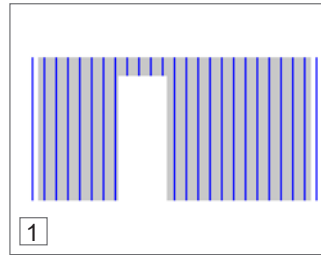
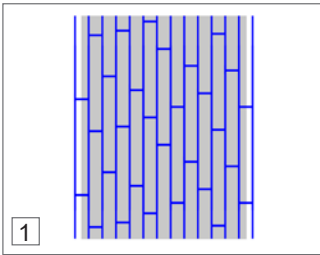

3. Mount across electric beams/beams with a max distance c/c 60 cm. When mounting on existing roof; test if the material has the strength to fix the screws. If not; locate the beams and fix the screws to them.
4. Cut to the first panel according to the correct width. When cutting with circular saw, the painted side should face down.

- 3/4. Fit blocks in inside and outside corners.

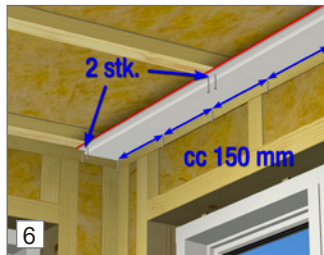
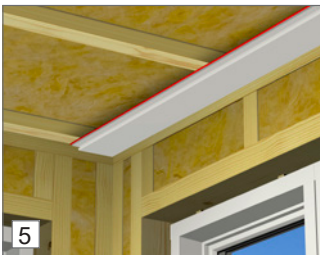

5. Mounted the first row after string / chalk cord for a straight start.  
NB: mount with approximately 10 mm distance to all walls.
6. Distance to wall and between nails; c/c 150 mm. Double nailing/screw on each beam.

5. The first panel is cut and mounted at a distance of 10 mm from the floor and ceiling.
6. Use a leveler so the installation gets a right start.

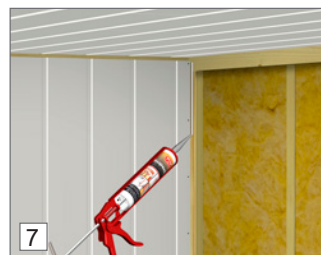
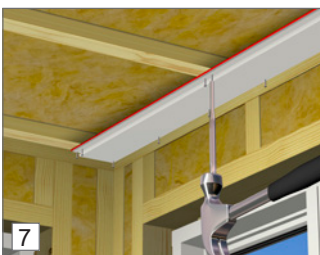

7. To avoid damage to the panel, use a nail setter when using nails.
8. The panel is to be spliced at the beam and should not be glued.

7. First panel on a new wall should be glued with Casco superfix or PL 400.
8. Double nailing/screw on each leak/beam.

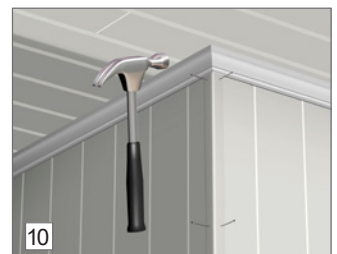
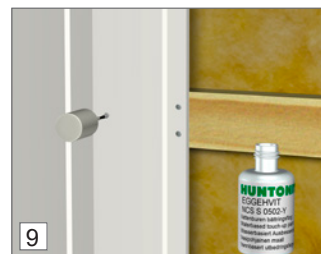
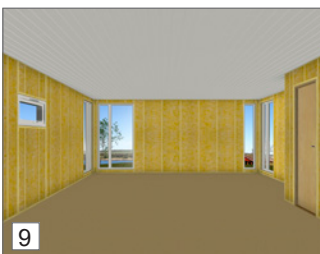

9. Mount the rest of the panel.  
Tadaa - your new ceiling is done!

9. Use correction paint delivered in 20 ml to cover marks made by screws and nails.
10. For external and internal corners; use Huntonit's corner profile.

You may mount recessed down lights in all our ceiling panels. You can also install our panels in wet rooms, provided normal ceiling height and good ventilation is available.

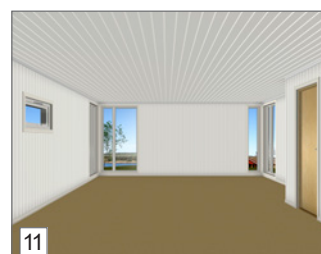

11. Tadaa - your walls are done!